



Mile 13

B3092 to GILLINGHAM

WALK OR JOG ALONG THE ROUTES SHOWN TO THE START (IN STATION ROAD) FROM THE HIGH SCHOOL (please allow 10 mins)

**STARTS**  
Station Road  
Half 10.30am  
5K 10.45am

**EARPHONE FREE RACE**  
ENJOY THIS RACE SAFELY  
Please do not wear your headphones - you will be disqualified if you do!

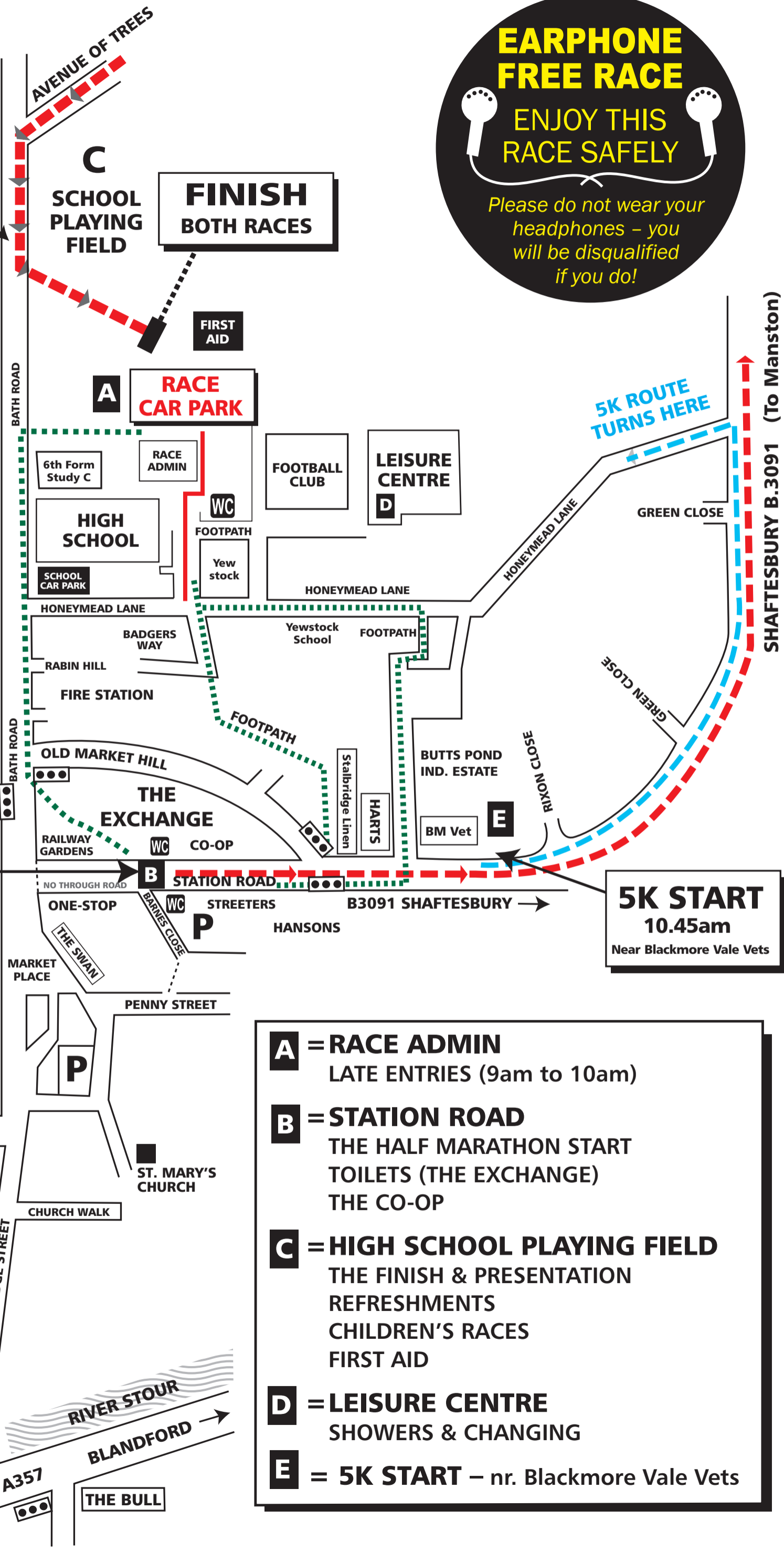

THOMAS HARDY'S HOUSE

Recreation Ground

THE MILL

- A** = RACE ADMIN  
LATE ENTRIES (9am to 10am)
- B** = STATION ROAD  
THE HALF MARATHON START  
TOILETS (THE EXCHANGE)  
THE CO-OP
- C** = HIGH SCHOOL PLAYING FIELD  
THE FINISH & PRESENTATION  
REFRESHMENTS  
CHILDREN'S RACES  
FIRST AID
- D** = LEISURE CENTRE  
SHOWERS & CHANGING
- E** = 5K START - nr. Blackmore Vale Vets

SHERBORNE

THE BULL

SHAFTESBURY B.3091 (To Manston)